

Ethnicraft

ASSEMBLY INSTRUCTIONS FOR BENCH INSTALLATION

OAK POLISHED IMPERFECT BENCH

| CODE | DESCRIPTION |
|-------|--|
| 51321 | OAK POLISHED IMPERFECT BENCH 126/35/46 |
| 51322 | OAK POLISHED IMPERFECT BENCH 146/35/46 |
| 51323 | OAK POLISHED IMPERFECT BENCH 166/35/46 |
| 51324 | OAK POLISHED IMPERFECT BENCH 186/35/46 |

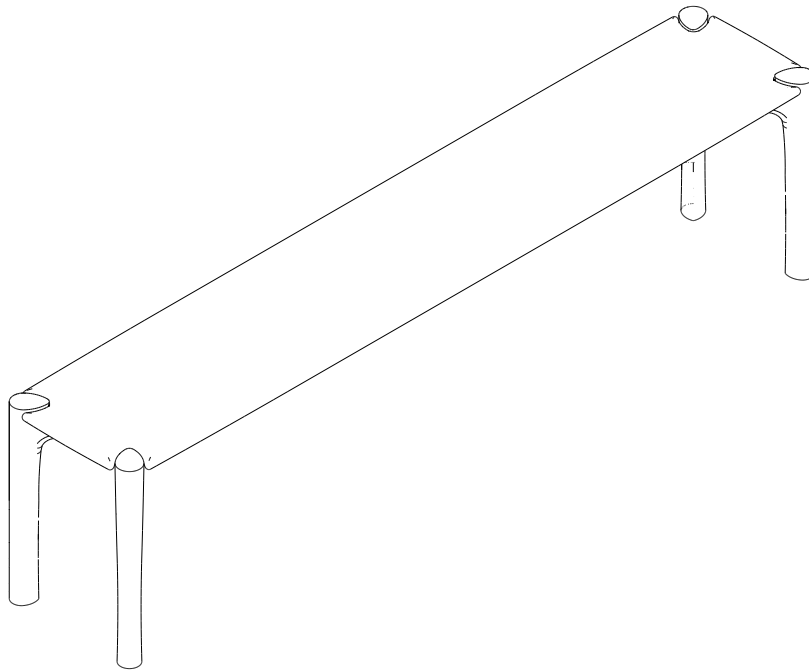

OAK POLISHED IMPERFECT BENCH ASSEMBLY INSTRUCTIONS FOR BENCH INSTALLATION

NOTE

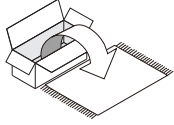

- CAREFULLY OPEN THE CARTON,
- REMOVE CONTENTS AND LAY OUT ON CARPET OR THE PACKAGING CARTON BOX OR OTHER PROTECTIVE SURFACE TO AVOID DAMAGE.
- CHECK PACKAGE CONTENTS TO ASSURE ALL THE NECESSARY HARDWARE AND PARTS ARE RECEIVED UNDAMAGED.
- DO NOT USE DAMAGE OR DEFECTIVE PARTS/HARDWARE.
- CONTACT ETHNICRAFT FOR ANY MISSING PART AND /OR HARDWARE.



- READ THE ASSEMBLY INSTRUCTION BEFORE INSTALLATION AND CAREFULLY FOLLOW THE INSTRUCTION GIVEN.
- SEEK THE ADVICE OF A PROFESSIONAL IF YOU ARE NOT FAMILIAR WITH THESE INSTALLATIONS OR HAVE ANY DOUBTS ABOUT THE SAFETY OF THIS INSTALLATION.



- IT IS ADVISABLE TO DO THIS ASSEMBLY WITH MINIMUM OF 2 PERSONS.

PARTS TO ASSEMBLE

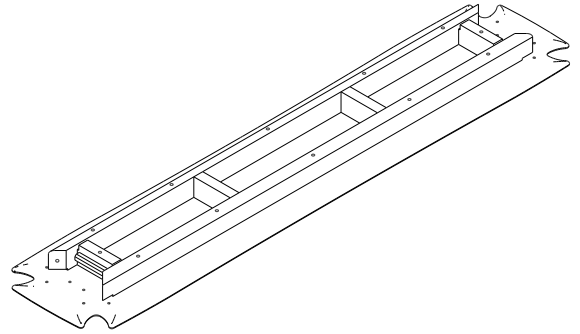

A TOP PANEL 1piece

| CODE | DESCRIPTION |
|-------|------------------|
| P4933 | TOP PANEL 126x35 |
| P4934 | TOP PANEL 146x35 |
| P4935 | TOP PANEL 166x35 |
| P4936 | TOP PANEL 186x35 |

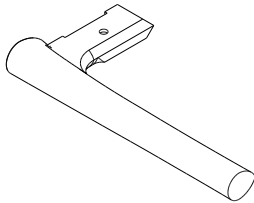

B LEG A 2 pieces

| CODE | DESCRIPTION |
|-------|-------------|
| P4937 | LEG A |

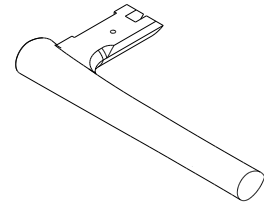

C LEG B 2 pieces

| CODE | DESCRIPTION |
|-------|-------------|
| P4938 | LEG B |

HARDWARE ENCLOSED

| | | |
|---|--|---|
| H0907 BOLT M6x40 (4pcs) | H0789 COUNTERSUNK SCREW M6x25 (8pcs) | |
| H0886 COUNTERSUNK SCREW M6x20 (12pcs) | H2260 L METAL PLATE A (2pcs) | H2261 L METAL PLATE B (2pcs) |

TOOL

(Included in packaged)



SYMBOLS



DIRECTION

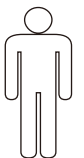

NUMBER OF PERSONS NEEDED



USE HAND



USE ALLEN KEY TO TIGHTEN

OAK POLISHED IMPERFECT BENCH ASSEMBLY INSTRUCTIONS FOR BENCH INSTALLATION

A INSTALLING METAL PLATE TO THE LEGS

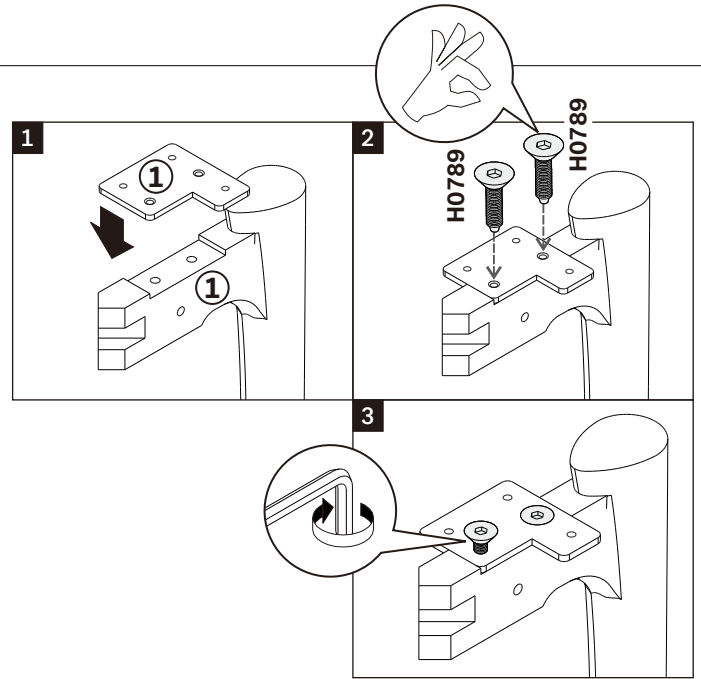
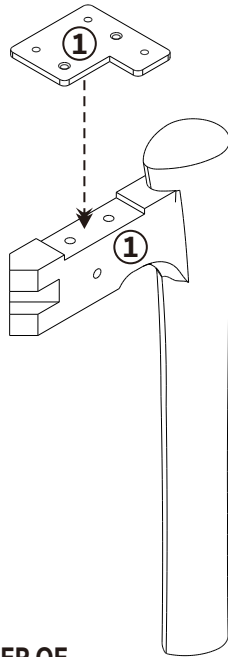

- USE COUNTERSUNK SCREW M6x25 (2X)
- TIGHTEN SCREWS FULLY
- REPEAT ABOVE STEP FOR OTHER LEGS

! PLEASE FOLLOW THE ORDER OF THE NUMBERS AS DISPLAYED ON EACH LEG

B INSTALLING LEGS TO APRON

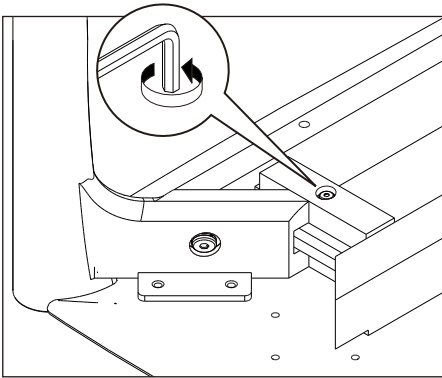

! IF THE SLOTS ON THE LEGS DOES NOT ALIGN WITH THE WOODEN BLOCK, LOOSEN THE BOLTS ON THE SHORTER APRON TO ADJUST THE SLOT POSITION.

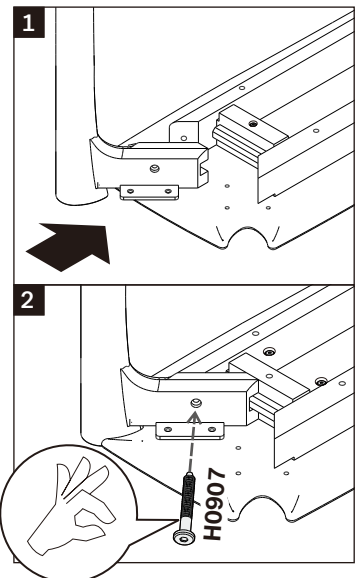
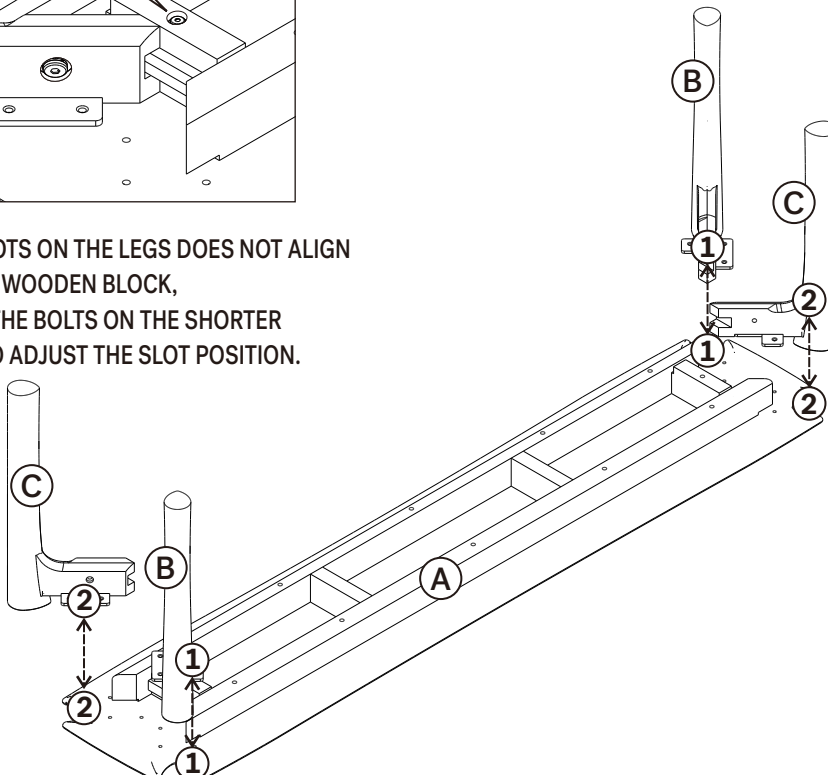

- USE BOLT M6x40 (4X)
- DO NOT TIGHTEN SCREWS FULLY

! - PLEASE FOLLOW THE ORDER OF THE NUMBERS AS DISPLAYED
- DO NOT TIGHTEN ALL SCREWS FULLY UNTIL THE FINAL STEP

OAK POLISHED IMPERFECT BENCH ASSEMBLY INSTRUCTIONS FOR BENCH INSTALLATION

C INSTALLING METAL PLATE SCREWS

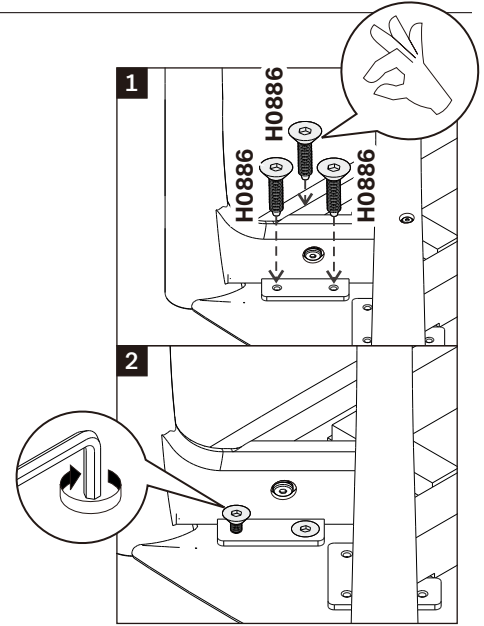
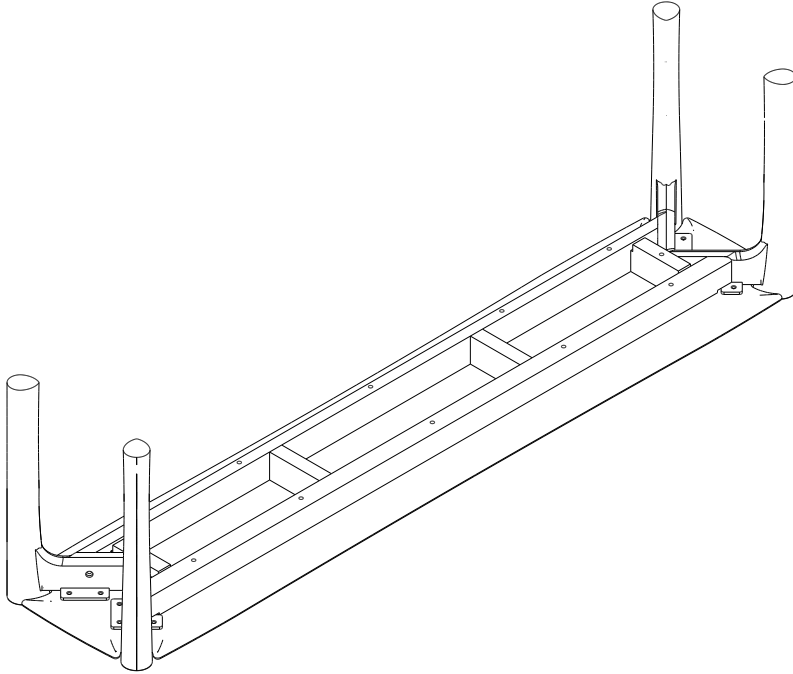

- ⚠ - USE COUNTERSUNK SCREW M6x20 (12X)
- DO NOT TIGHTEN SCREWS FULLY

D FLIP ITEM

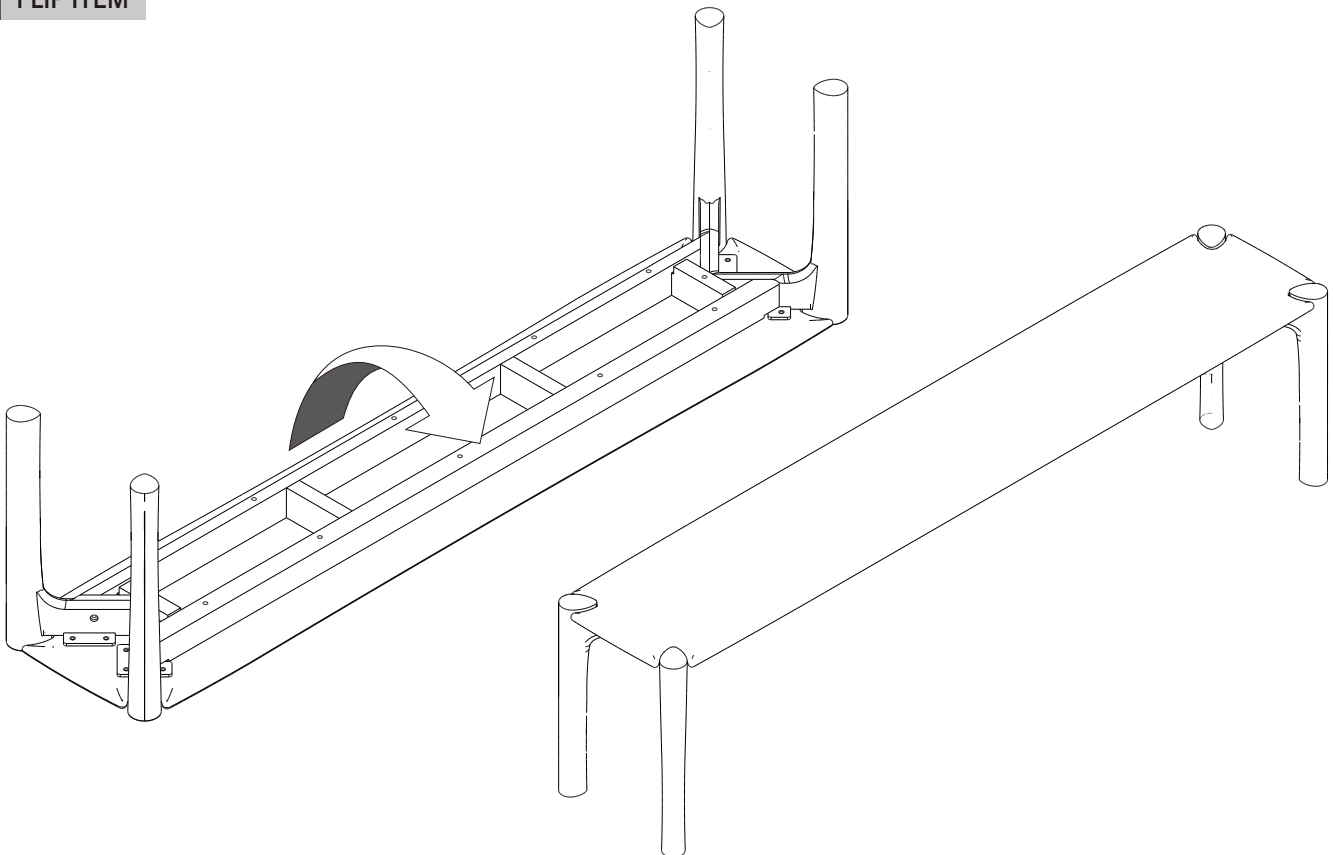

OAK POLISHED IMPERFECT BENCH ASSEMBLY INSTRUCTIONS FOR BENCH INSTALLATION

E TIGHTEN ALL SCREWS

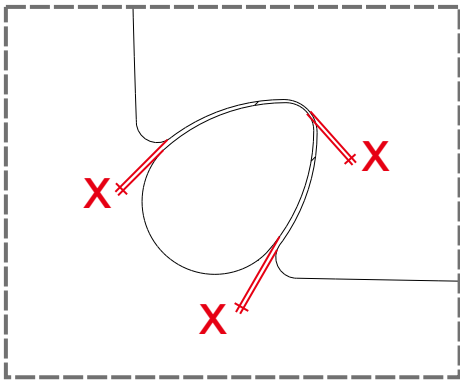

⚠ MAKE SURE THESE ARE CENTERED BEFORE TIGHTENING THE SCREWS

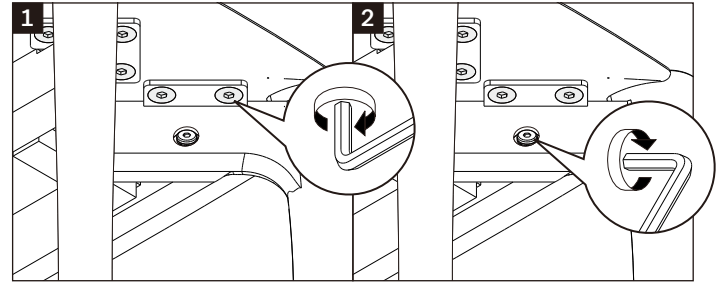
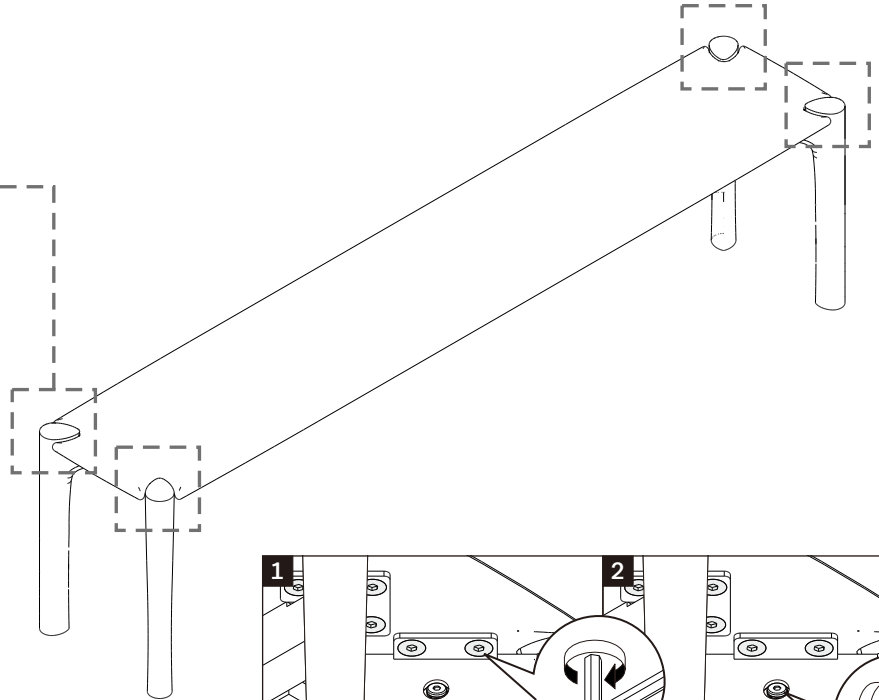

⚠ FULLY TIGHTEN ALL SCREWS ON THE LEGS TO THE TOP PANEL & APRON

F FINISH

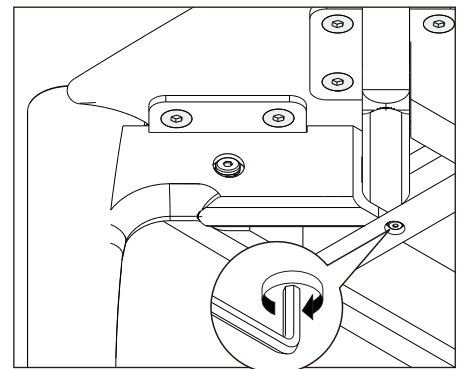
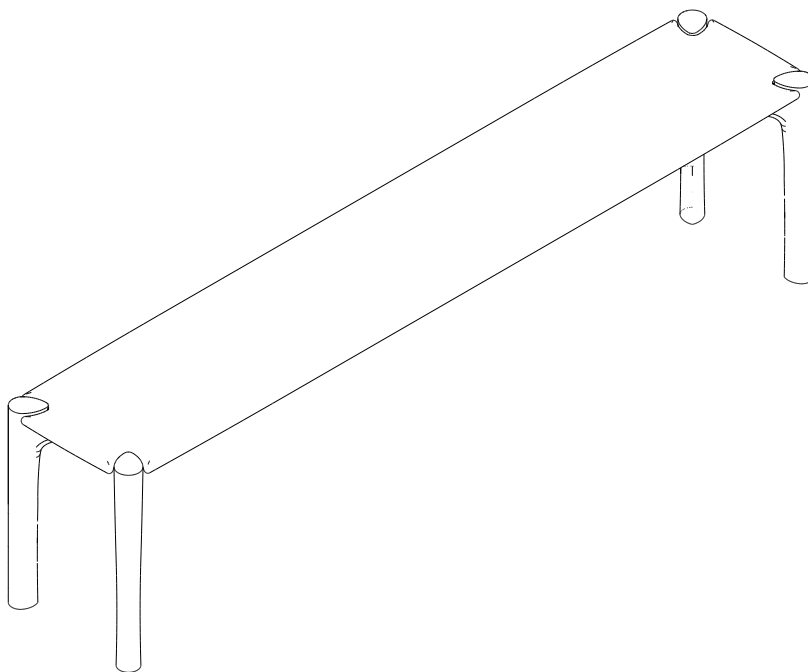

⚠ TIGHT BACK THE BOLTS IN THE SHORTER APRON IF PREVIOUSLY LOOSENED